



How to configure 26 controller in HCAC for platform fire alarm linkage

Title:	How to configure 26 controller in HCAC for platform fire alarm linkage	Version:	v1.0	Date:	06/13/2023
Product:	Non-video product			Page:	

Preparation

Type	Model	Version
Software	HikCentral Access Control	V2.0.1
Controller	DS-K2604T	V1.1.0

How to configure 26 controller in HCAC for platform fire alarm linkage

Introduction: If you want to 26 series controller trigger the fire alarm interface after linking other access control devices to open the door, you can follow this article to configure.

一、 Check the equipment arming status

(1)As the platform is linked to multiple controllers to open the door, it is necessary to check whether the current trigger controller is armed by the HCAC platform, and if the trigger fire interface has the following trigger event, then the event can be configured as the source of the linked event.

Title:	How to configure 26 controller in HCAC for platform fire alarm linkage	Version:	v1.0	Date:	06/13/2023
Product:	Non-video product			Page:	

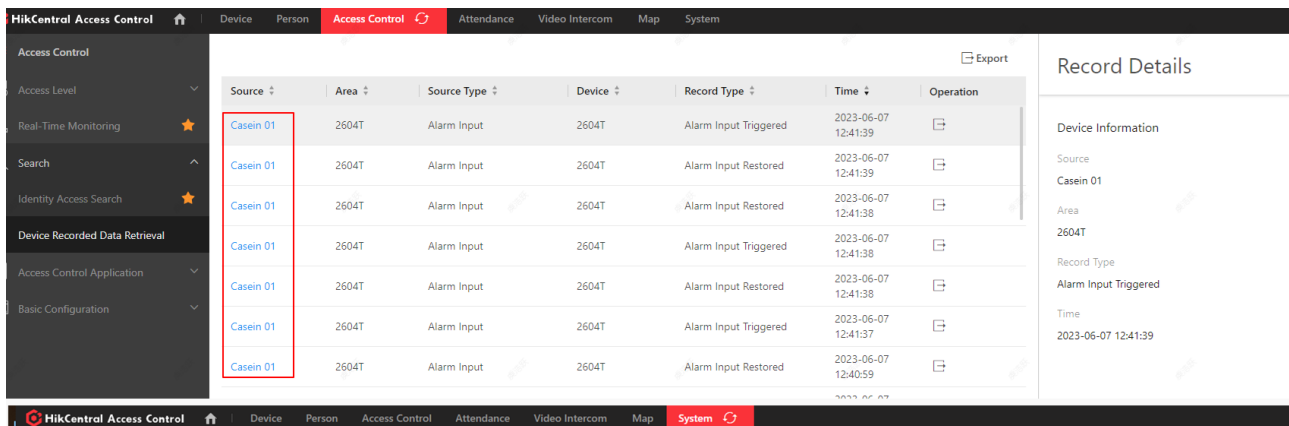
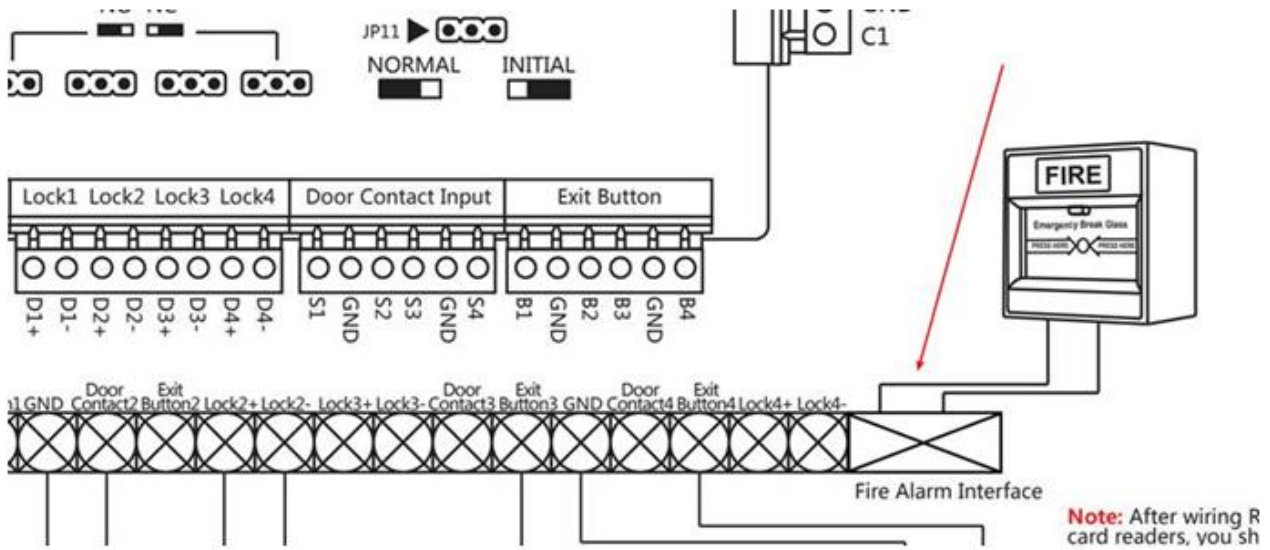

二、 Configuration linkage

(1) Click normal event and alarm under the system menu, add a new linkage configuration.

Title:	How to configure 26 controller in HCAC for platform fire alarm linkage	Version:	v1.0	Date:	06/13/2023
Product:	Non-video product			Page:	

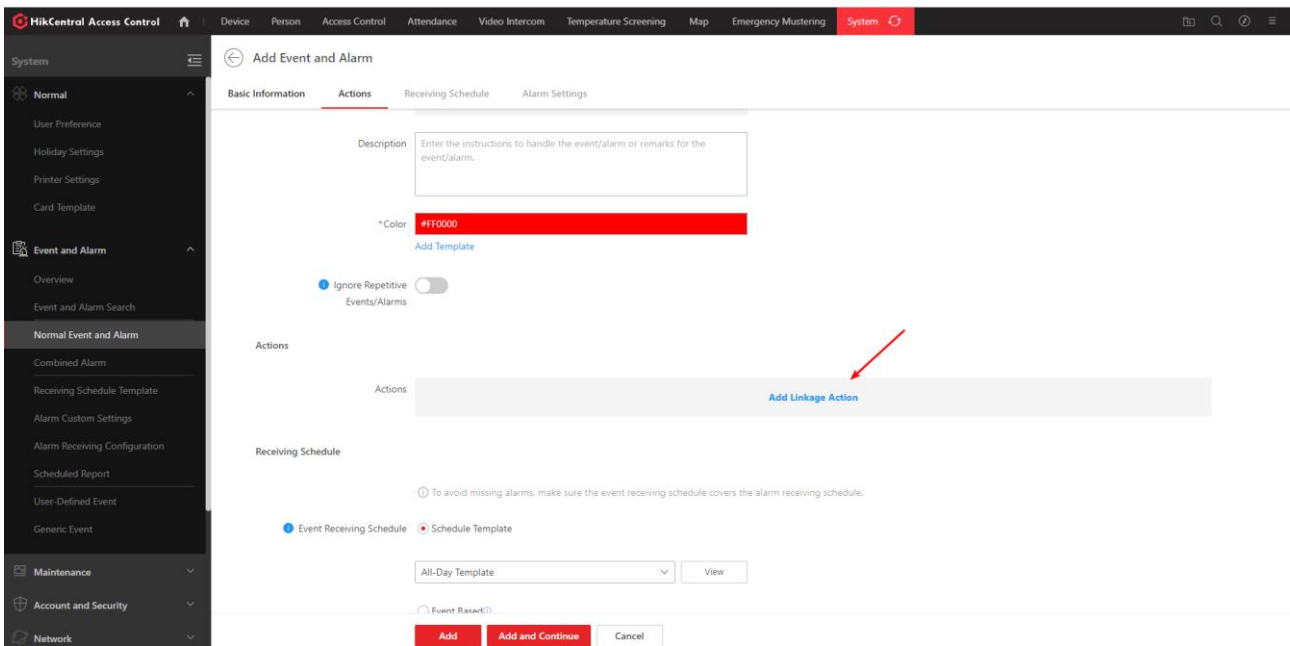
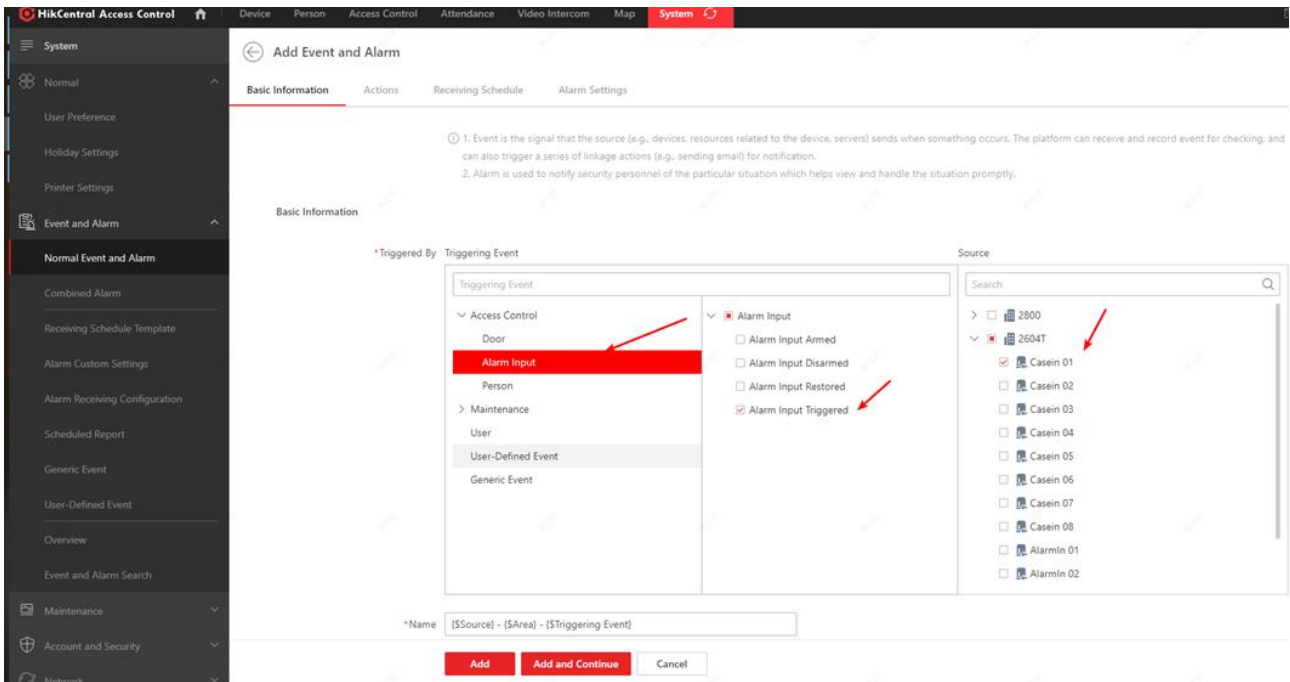

(2) If the linkage event is successfully configured, it will show a configured linkage event.

Title:	How to configure 26 controller in HCAC for platform fire alarm linkage	Version:	v1.0	Date:	06/13/2023
Product:	Non-video product			Page:	

The screenshot displays the HikCentral Access Control software interface. The top navigation bar includes tabs for Device, Person, Access Control, Attendance, Video Intercom, Map, and System. The left sidebar lists various system settings such as Normal, User Preference, Holiday Settings, Printer Settings, and Event and Alarm. The main content area shows a summary of system status with two sets of counters: 'Total' (1 Configured, 0 Disabled, 0 Exception) and 'Access Control' (1 Configured, 0 Disabled, 0 Exception). Below the summary is a table of events with columns for Event Name, Source, Triggering Event, Trigger Alarm, Alarm Priority, Status, and Device Alarm Status. A single event is listed: 'Casein 01 - 2604T - Alarm Input Triggered' with Source 'Casein 01', Triggering Event 'Alarm Input Triggered', Trigger Alarm 'No', Alarm Priority 'Enabled', and Device Alarm Status 'Enabled'.

Event Name	Source	Triggering Event	Trigger Alarm	Alarm Priority	Status	Device Alarm Status
Casein 01 - 2604T - Alarm Input Triggered	Casein 01	Alarm Input Triggered	No	Enabled	Enabled	Enabled

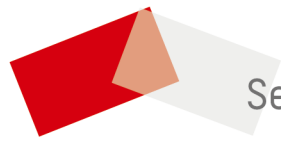

See Far, Go Further